



FRANCIS SCOTT KEY MALL FREDERICK, MD

PREIT®

FRANCIS SCOTT KEY MALL

Located in a sought-after bedroom community of Washington, DC and Baltimore, both 45 miles away.

32% of the households earn \$150,000+ per year and average home values exceed \$430,000.

Average daily vehicle traffic exceeds 242,000+; with 110,000 daily travelers on I-270 commuting to DC Metro area and 91,000 on I-70 commuting to Baltimore metro area.

Average occupancy of 95% for the last five years.

The mall is located in a prime retail district with over 920,000 sf of additional retail space within one mile.

Ranked in the top 10% Healthiest Counties in the US by US News & World Report.

In November 2022, Frederick County completed a \$93 million project to reconstruct and expand the roadways surrounding the mall (I-270/MD 85 Buckeystown Pike) to reduce congestion and enhance safety.



CENTER SIZE
755,000 sf

INLINE GLA
394,000 sf

YEAR OPENED
1978

YEAR REDEVELOPED
1991

ANCHORS & JUNIOR ANCHORS

Macy's	139,000 sf
JCPenney	101,000 sf
DICK's Sporting Goods	50,000 sf
Value City Furniture	47,500 sf
Barnes & Noble	29,000 sf
DSW	17,500 sf

RESTAURANTS & OUTPARCELS

BJ's Restaurant and Brewhouse	8,500 sf
Red Robin	5,700 sf

FEATURED RETAILERS

American Eagle Outfitters
Bath & Body Works
The Children's Place
Foot Locker
H&M
Hollister
Hot Topic
Journeys
Kay Jewelers
Torrid
Victoria's Secret
Yankee Candle

FRANCIS SCOTT KEY MALL

Located on Spectrum Dr
minutes from I-270 N exit 31A;
Rte 85 Buckeystown Pike
5500 Buckeystown Pike
Frederick, MD 21703

POPULATION
370,137

HOUSEHOLDS
132,779

AVERAGE HHI
\$144,426

% OF HOUSEHOLDS
WITH INCOMES > \$100K
57%

AVERAGE HOME VALUE
\$430,299

MEDIAN AGE
40.1

TOTAL BUSINESSES
12,584

DAYTIME POPULATION
183,140

Source: ESRI 2022

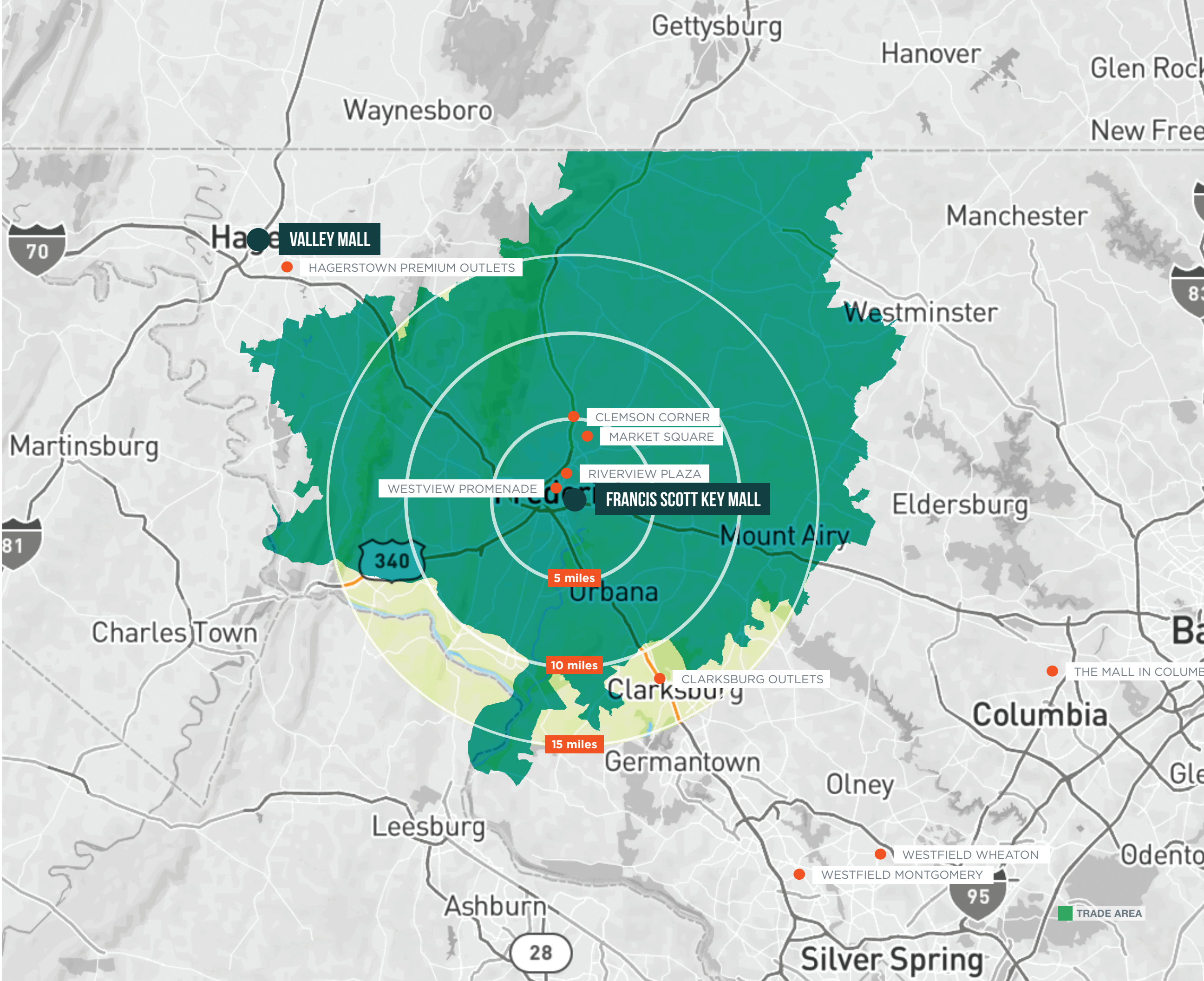

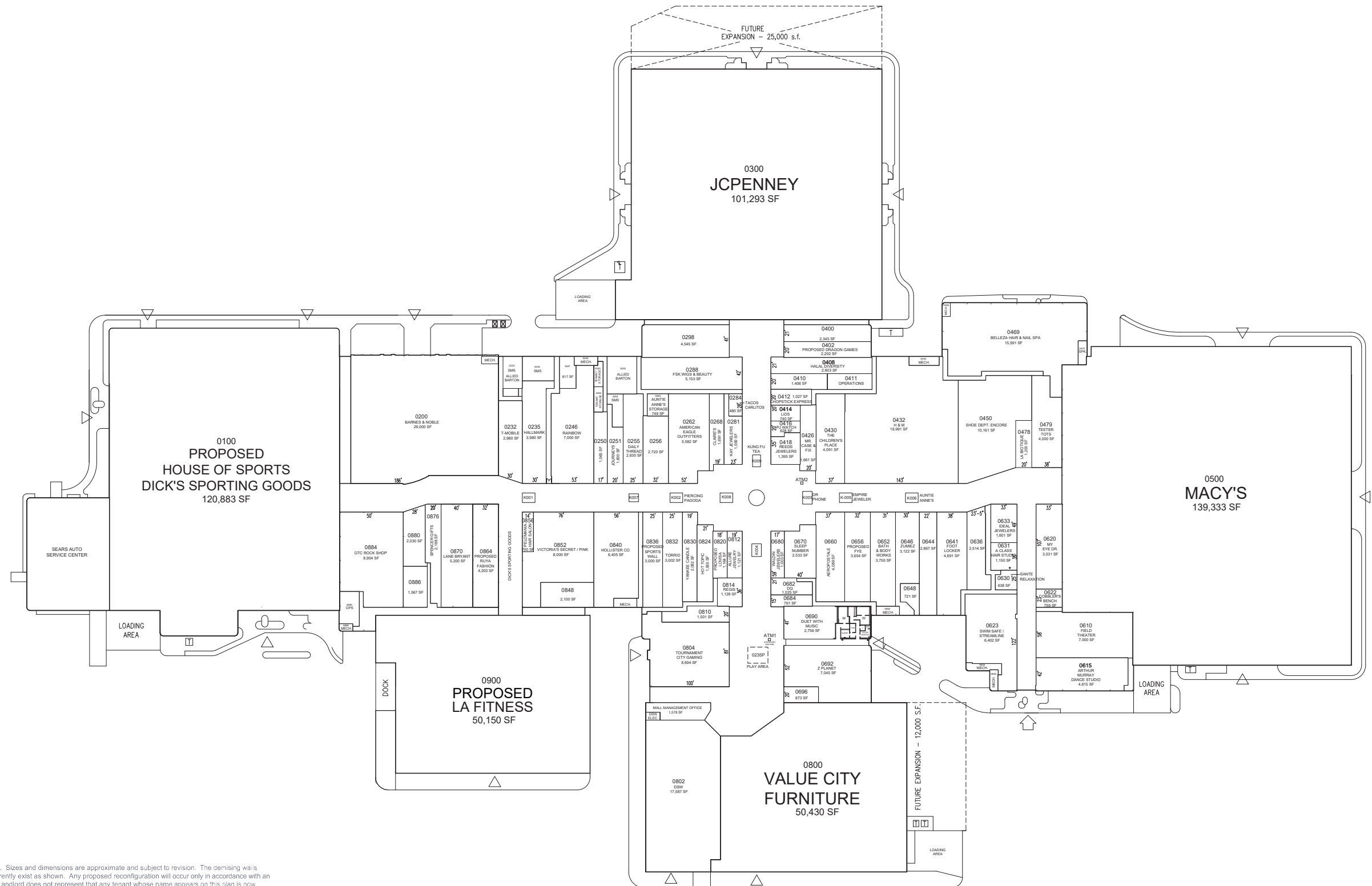

This drawing is diagrammatic. Sizes and dimensions are approximate and subject to revision. The demising wall/s and/or lease line may not currently exist as shown. Any proposed reconfiguration will occur only in accordance with an executed lease agreement. Landlord does not represent that any tenant whose name appears on this plan is now occupying or will continue to occupy any portion of the shopping center.