



**DARTMOUTH MALL** DARTMOUTH, MA

**PREIT**<sup>®</sup>

# DARTMOUTH MALL

Market dominant enclosed mall within a 30 mile radius.

A 23,000 sf, first-to-market ALDI joined the property in Fall of 2021 with Burlington opening in 2020.

Located in the retail hub of Southeastern Massachusetts with over two million square feet of retail space within a half mile.

20 minutes from the vacation destinations of Newport, RI and Cape Cod, MA, and near the major metropolitan areas of Providence (20 minutes) and Boston (50 minutes).

Over 26,000 high school and college students within 15 mile radius, highlighted by UMass – Dartmouth.

Area is home to the number one commercial fishing seaport along the East Coast and emerging epicenter for offshore wind industry, contributing \$1 billion to the local economy.



**CENTER SIZE**  
670,000 sf

**INLINE GLA**  
322,000 sf

**YEAR OPENED**  
1971

**YEAR REDEVELOPED**  
2000

## ANCHORS & JUNIOR ANCHORS

Macy's	140,000 sf
JCPenney	100,000 sf
AMC Theatres	44,900 sf
Burlington	43,800 sf
ALDI	23,880 sf
Old Navy	17,800 sf

## RESTAURANTS & OUTPARCELS

Olive Garden	10,000 sf
Buffalo Wild Wings	6,800 sf
Panera Bread	4,400 sf
Taco Bell	1,900 sf
Skechers	10,377 sf

## FEATURED RETAILERS

American Eagle Outfitters  
Carter's OshKosh B'gosh  
David's Bridal  
EbLen's  
Express  
Five Below  
francesca's  
H&M  
Hollister  
Journeys  
Men's Wearhouse  
Newbury Comics  
Shoe Dept. ENCORE  
Torrid

Victoria's Secret/Pink  
Windsor  
Yankee Candle  
Zumiez

# DARTMOUTH MALL

Intersection of Rte 6 and Faunce Corner Road; off I-195 exit 22  
200 Dartmouth Mall  
Dartmouth, MA 02747

## POPULATION

404,087

## HOUSEHOLDS

164,085

## AVERAGE HHI

\$98,343

## % OF HOUSEHOLDS WITH INCOMES > 100K

47%

## AVERAGE HOME VALUE

\$448,737

## MEDIAN AGE

42.7

## TOTAL BUSINESSES

15,520

## DAYTIME POPULATION

387,917

Source: ESRI 2022

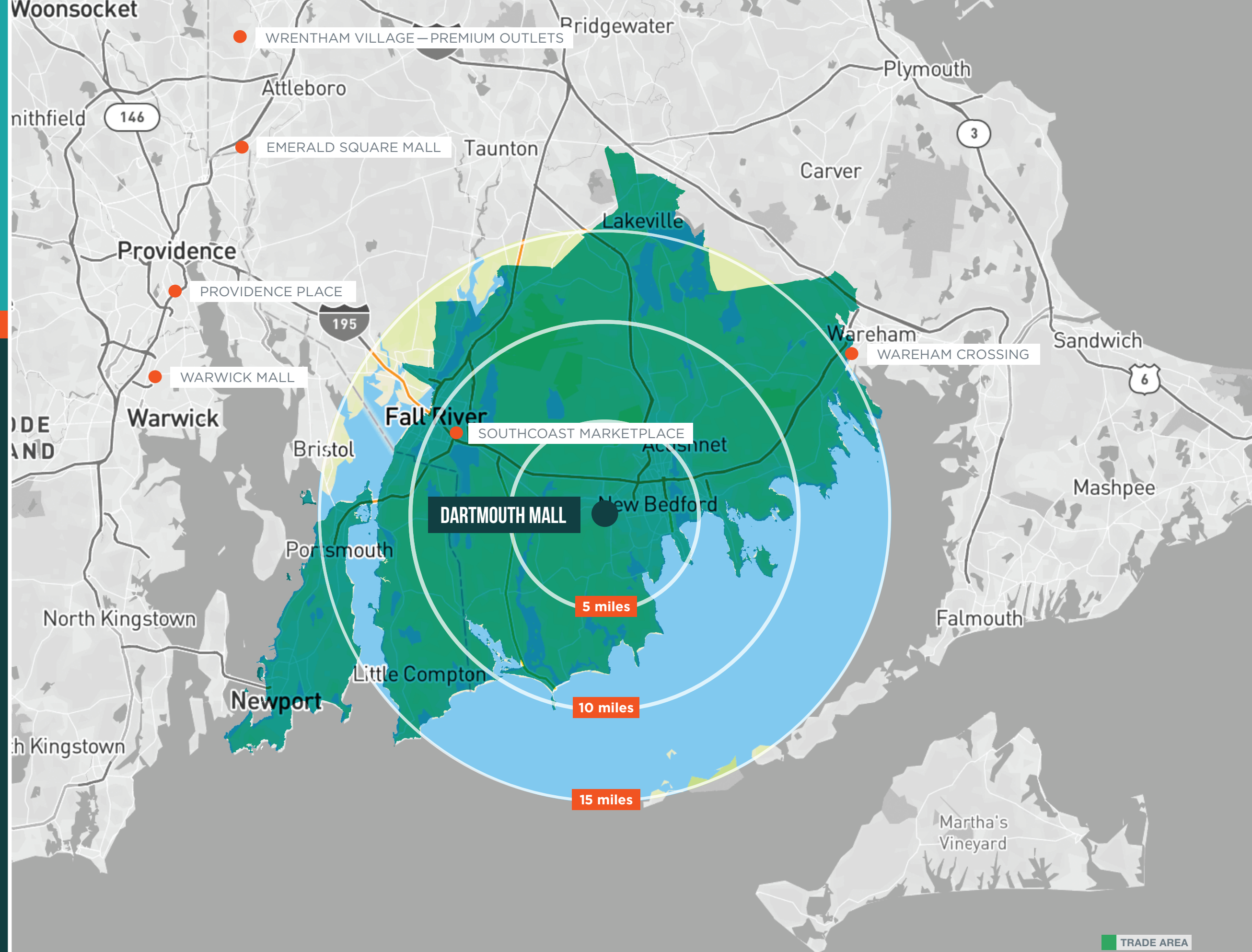

TRADE AREA

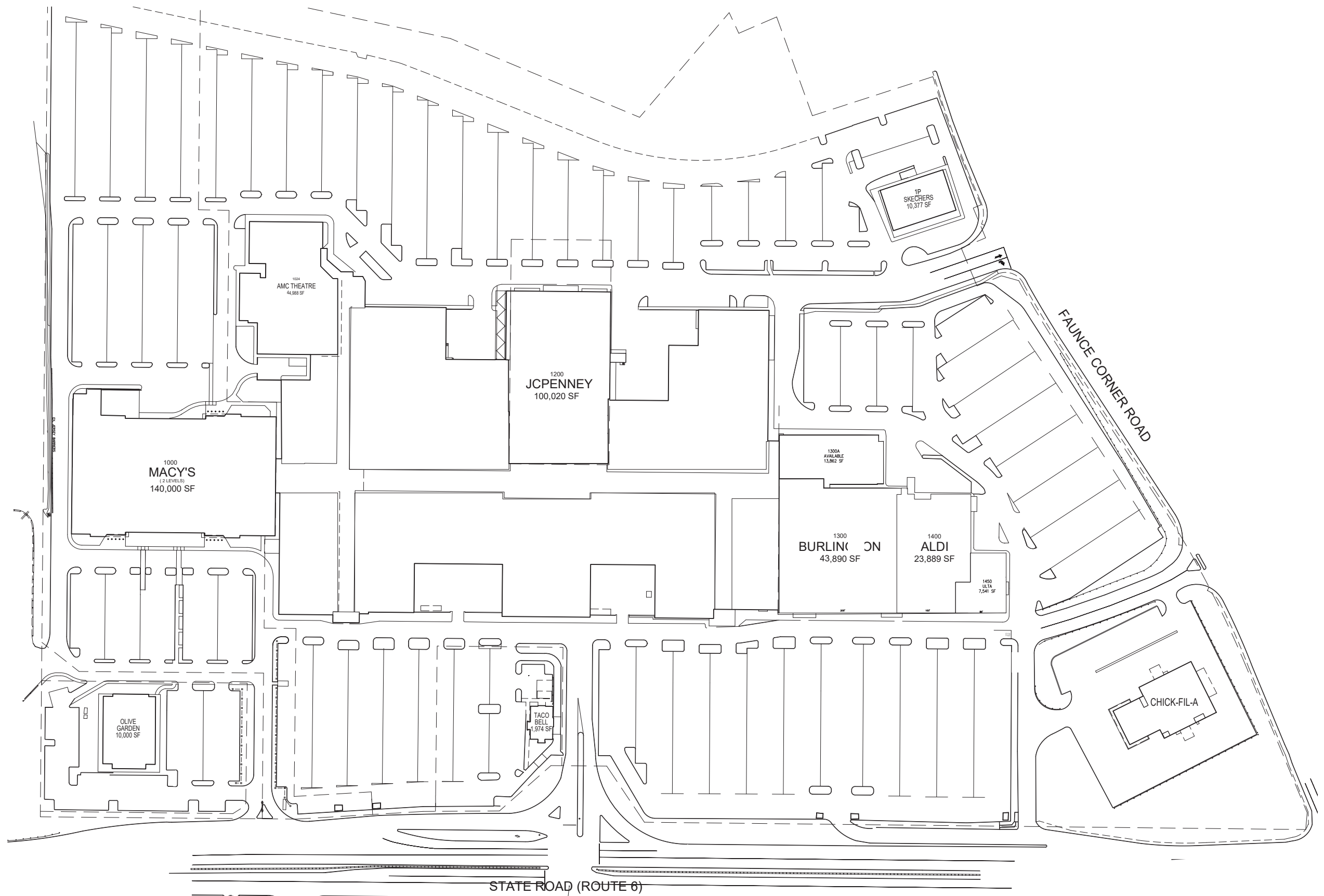

This drawing is diagrammatic. Sizes and dimensions are approximate and subject to revision. The demising walls and/or lease line may not currently exist as shown. Any proposed reconfiguration will occur only in accordance with an executed lease agreement. Landlord does not represent that any tenant whose name appears on this plan is now occupying or will continue to occupy any portion of the shopping center.

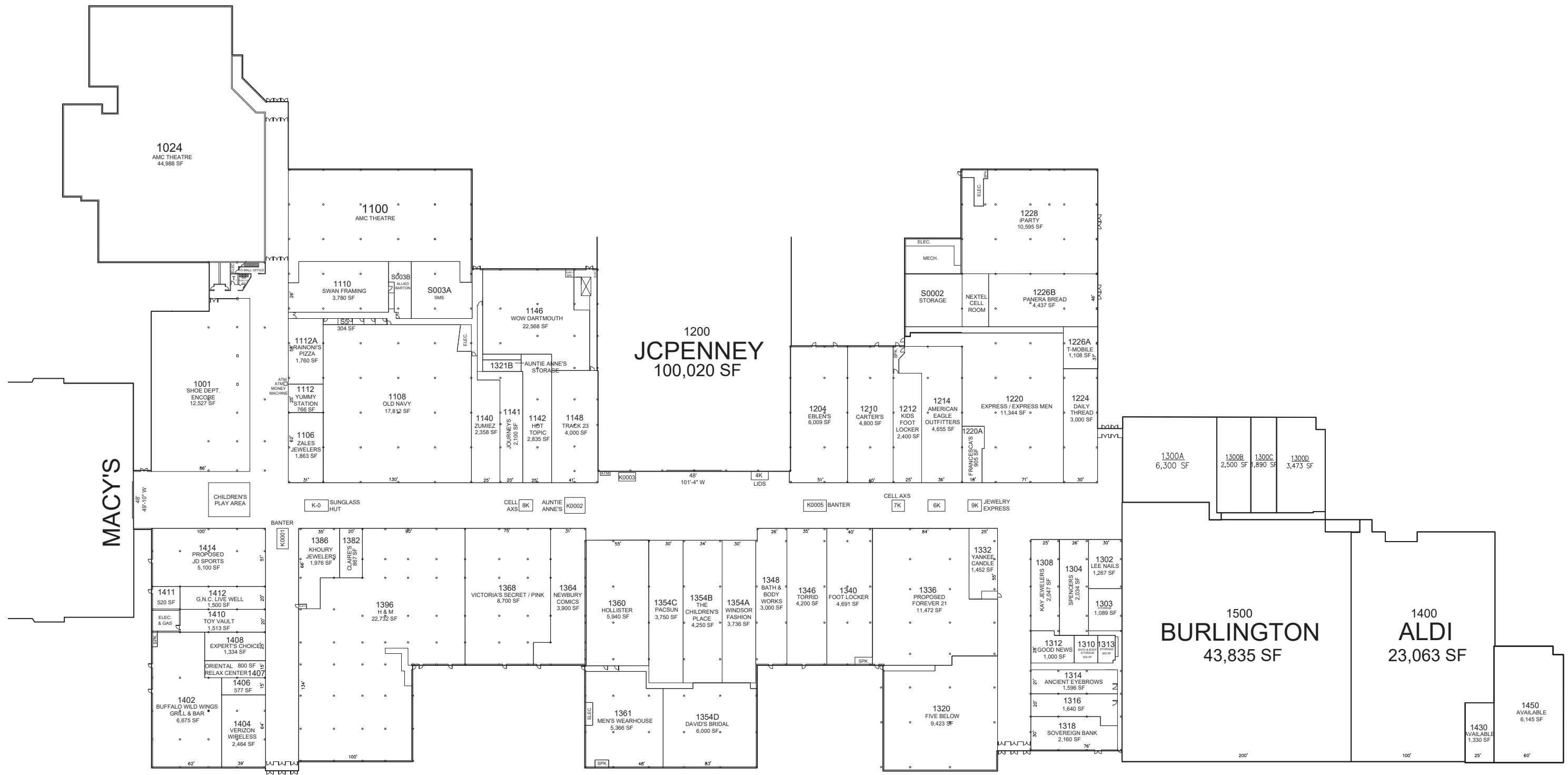

This drawing is diagrammatic. Sizes and dimensions are approximate and subject to revision. The demising walls and/or lease line may not currently exist as shown. Any proposed reconfiguration will occur only in accordance with an executed lease agreement. Landlord does not represent that any tenant whose name appears on this plan is now occupying or will continue to occupy any portion of the shopping center.